



BLE Smart Tag Midi

Small & portable device
which pinpoints the
location of its bearer

Key features

- Compatible with Ubudu BLE V1 (uplink) & V2 (downlink) setups
- Firmware upgradeable
- Built-in accelerometer
- LED visual indicator
- Attachable form factor
- 23+ months autonomy, depending on scenario
- Wearable form factor
- Powered by replacable coin battery (1000mAh)
- Designed & manufactured in EU
- Each unit carefully tested
- 1 year warranty
- Dimensions 65 x 45 x 17.5mm
- Weight ~42g
- CE certified
- IP54 ready for industrial areas
- IP67 optional
- Oper. temp. $-30^{\circ}\text{C} \div 60^{\circ}\text{C}$
- Available in white and gray (other colours upon request)

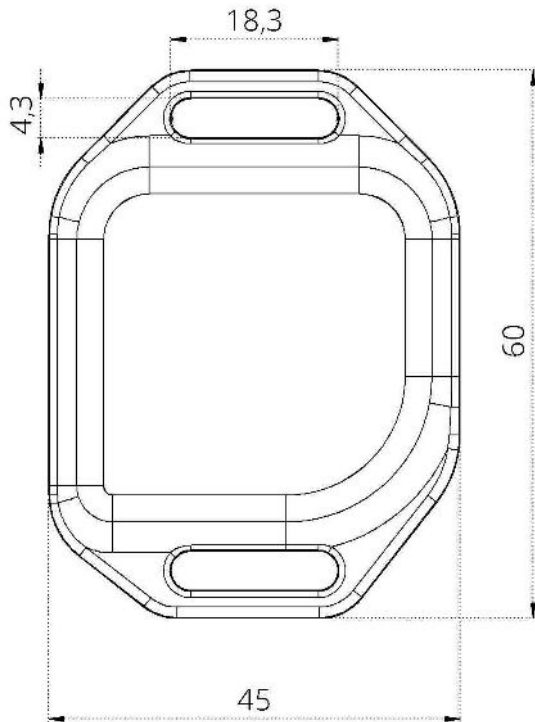

Front view

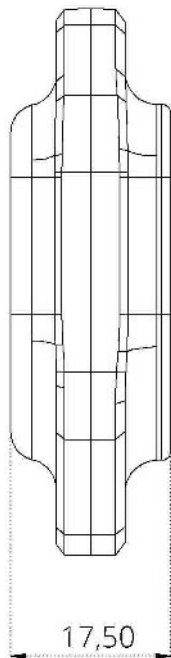

Side view